



LS-Type for Stage Equipment

Entertainment flush-mounted inclined socket-outlets and straight socket outlets

Socket Design

- Enclosure and spring lid colour RAL 9005 black
- Compliant with EN 60309-1 and -2
- Enclosure, insert and spring lid in insulating, thermoplastic, self-extinguishing material
- Flange with anti-ageing gasket
- PN...PI - PN...PQ types (IP44), spring lid
- Terminals with retained screws
- IP44 degree of protection (EN 60529)

Part No.	Number of Poles	Frequency Hz	Voltage V	Earthing contact position H
PN 1663 PI, PN 1663 PQ	2P+Earth	50 and 60	200 - 250	6
PN 1664 PI, PN 1664 PQ	3P+Earth	50 and 60	380 - 415	6
PN 1665 PI, PN 1665 PQ	3P+N+Earth	50 and 60	200/346 - 240/415	6

16A flush-mounting inclined socket-outlets

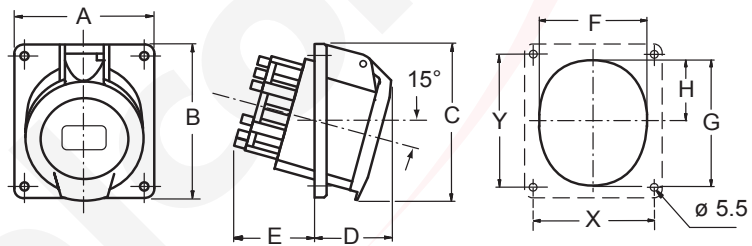

Part No	A	B	C	D	E	F	G	H	X	Y
PN 1663 PI	64	82	82	38	46	52	62	30	52	60
PN 1664 PI	64	82	82	42	47	57	65	28	52	60
PN 1665 PI	92	100	100	43	47	66	78	37.5	77	85

16A flush-mounting straight socket-outlets

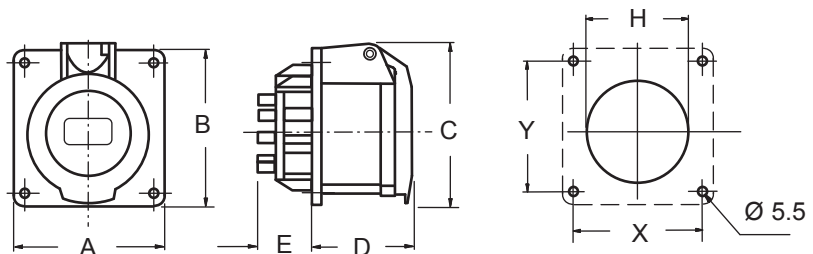

Part No	A	B	C	D	E	H	X	Y
PN 1663 PQ	65	65	71	52	27	60	52	52
PN 1664 PQ	65	65	75	53	27	61.5	52	52
PN 1665 PQ	80	80	86	53	27	70	60	60